

## Contents

Symbols used in this manual . . . . .	13
Symbols on the power tool. . . . .	13
For your safety . . . . .	13
Noise and vibration . . . . .	14
Technical specifications . . . . .	15
Overview . . . . .	16
Instructions for use. . . . .	17
Maintenance and care . . . . .	21
Disposal information. . . . .	21
CE-Declaration of Conformity. . . . .	22
Exemption from liability . . . . .	22

## Symbols used in this manual



### WARNING!

Denotes impending danger.  
Non-observance of this warning may result in death or extremely severe injuries.



### CAUTION!

Denotes a possibly dangerous situation.  
Non-observance of this warning may result in slight injury or damage to property.



### NOTE

Denotes application tips and important information.

## Symbols on the power tool



Before switching on the power tool, read the operating manual!



Wear eye protection!



Wear ear protection!



Do not use in the rain or leave outdoors while it is raining!



Keep bystanders away!



Disposal information for the old machine (see page 21)!

## For your safety



### WARNING!

Before using the power tool, please read and follow:

- these operating instructions,
- the "General safety instructions" on the handling of power tools in the enclosed booklet (leaflet-no.: 315.915),
- the currently valid site rules and the regulations for the prevention of accidents.

This power tool is state of the art and has been constructed in accordance with the acknowledged safety regulations. Nevertheless, when in use, the power tool may be a danger to life and limb of the user or a third party, or the power tool or other property may be damaged.

- The power tool may be operated only if it is as intended,
- in perfect working order.

Faults which impair safety must be repaired immediately.

### Intended use

The battery operated blower BW 18.0-EC is designed

- for commercial use in industry and trade. Possible applications are cleaning large surfaces of wood chips and other large particles by means of compressed air.

Not permitted are

- Air sweeping hot, combustible or explosive materials.
- Air sweeping dust containing hazardous substances (e.g. hardwood flour or quartz in concrete dust) or classified as hazardous material.

## Safety instructions for battery operated blowers



### **WARNING!**

**Read and follow all safety instructions and other instructions in this manual.**

*Failure to observe the warnings and instructions may cause an electric shock, fire and/or serious injuries. Keep this manual in a safe place for subsequent use.*

- **Ensure that no persons in the vicinity are injured by foreign particles that are swept up into the air.**
- **Keep fingers away from the openings of the power tool during use. Only operate the blower with the nozzle attached.**  
The rotating blower can cause injuries.
- **Do not air sweep substances that are hazardous to health, such as beechwood dust or oak dust, stone dust, asbestos.**  
These substances have been found to be carcinogenic.
- **Do not air sweep liquids.**  
Any ingress of liquid increases the risk of electric shock.
- **Do not expose the device to rain or wet conditions.**  
The ingress of water in the motor increases the risk of electric shock.
- **Ensure that the workplace is well ventilated.**
- **Wear additional personal protective equipment such as safety goggles and respirator (or breathing protection).**  
Wearing suitable protective equipment for the conditions reduces any exposure to hazardous substances.

## Noise and vibration

The noise and vibration values have been determined in accordance with EN 15503. The A evaluated noise level of the power tool is typically:

- Sound pressure level: 75 dB(A);
  - Sound power level: 95 dB(A);
  - Uncertainty K: 3 dB.
- Total vibration value:
- Emission value  $a_H$ : < 2.5 m/s<sup>2</sup>
  - Uncertainty K: 1.5 m/s<sup>2</sup>



### **CAUTION!**

*The indicated measurements refer to new power tools. Daily use causes the noise and vibration values to change.*



### **NOTE**

The vibration emission level given in this information sheet has been measured in accordance with a standardised test given in EN 15503 and may be used to compare one tool with another. It may be used for a preliminary assessment of exposure. The declared vibration emission level represents the main applications of the tool. However if the tool is used for different applications, with different accessories or poorly maintained, the vibration emission may differ. This may significantly increase the exposure level over the total working period. However if the tool is used for different applications, with different accessories or poorly maintained, the vibration emission may differ.

This may significantly decrease the exposure level over the total working period. Identify additional safety measures to protect the operator from the effects of vibration such as: maintain the tool and the accessories, keep the hands warm, organisation of work patterns.



### **CAUTION!**

*Wear ear protection at a sound pressure above 85 dB(A).*

## Technical specifications

		<b>BW 18.0-EC</b>
Machine type		Battery operated blower
Operating voltage	V	18
Battery	Ah	2.5 5.0
Charging time	min	max. 45
Idling speed		
– Stage 1	r.p.m.	10,600
– Stage 2	r.p.m.	14,200
– Stage 3	r.p.m.	18,000
max. air speed	m/s	80
max. air volume	m <sup>3</sup> /min	3.11
Weight according to “EPTA Procedure 01/2003” (without battery)	kg	1.28
Weight battery (5 Ah)	kg	0.72

## Overview

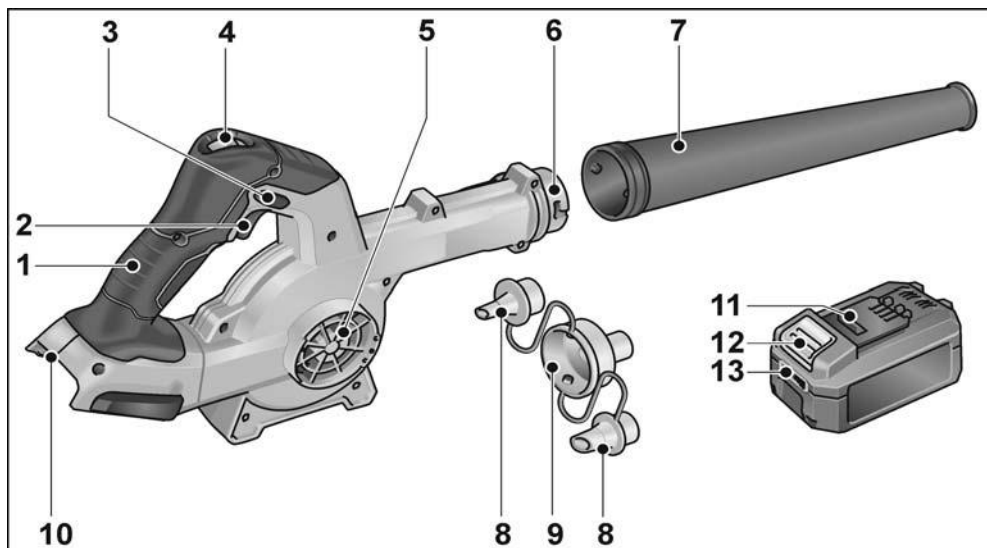

- |   |                               |    |                            |
|---|-------------------------------|----|----------------------------|
| 1 | Handle                        | 8  | Reducing nozzles           |
| 2 | ON/OFF switch                 | 9  | Adapter                    |
| 3 | Lock button                   | 10 | Slot for battery           |
| 4 | Air volume regulator, 3 stage | 11 | Li-ion battery             |
| 5 | Air inlet                     | 12 | Release button for battery |
| 6 | Bayonet connection            | 13 | State of charge indicator  |
| 7 | Nozzle                        |    |                            |

## Instructions for use



### **WARNING!**

Remove the battery before carrying out any work on the power tool.

### Before switching on the power tool

Unpack power tool and accessories and check that no parts are missing or damaged.

### Inserting/replacing the battery

- Press the charged battery into the power tool until it clicks into place.



- To remove, press the release button (1.) and pull out the battery (2.).

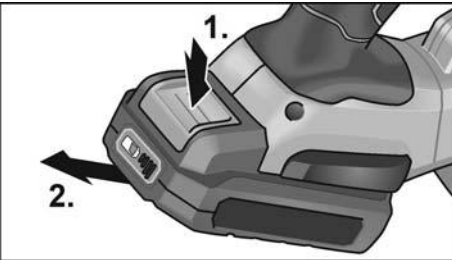

### **CAUTION!**

Protect the battery contacts when the battery is not being used. Loose metal parts may short-circuit the contacts – Explosion and fire hazard!

## Battery state of charge

- Press the button to check the state of charge at the state of charge indicator LEDs.

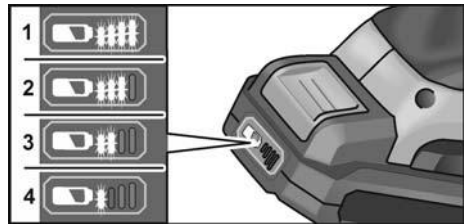

The indicator goes out after 5 seconds.

If one of the LEDs flashes, the battery must be recharged. If none of the LEDs light up after the button is pressed, the battery is faulty and must be replaced.

## Attaching the nozzle



### **WARNING!**

Remove the battery before carrying out any work on the power tool.

### Assemble

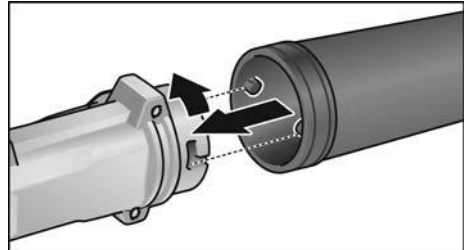

- Attach the nozzle to the bayonet connection by turning lightly in anti-clockwise direction.
- Check that the adapter is securely seated!

### Disassemble

- Remove in reverse order.

## Attaching the reducing nozzles

### **⚠ WARNING!**

Remove the battery before carrying out any work on the power tool.

### Mounting on the bayonet connection

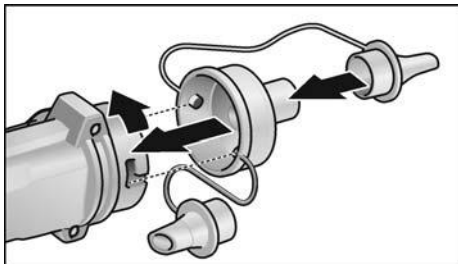

- Attach the adaptor to the bayonet connection by turning lightly in anti-clockwise direction.
- Check that the adapter is securely seated.
- Fit the relevant reducing nozzle.

### Disassemble

- Remove in reverse order.

### Mounting on the air inlet

### **i NOTE**

The adapter is mounted on the air inlet to extract air.

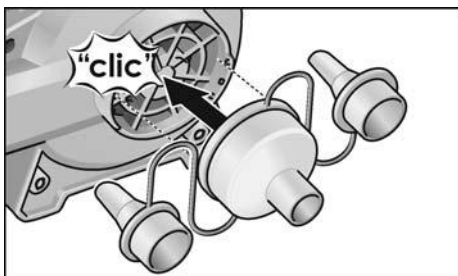

- Fit the adapter on the air inlet.
- Fit the relevant reducing nozzle.

### Disassemble

- Remove in reverse order.

## Switching on and off

### **⚠ CAUTION!**

- Never direct the nozzle of the power tool at other persons or yourself.
- Use personal protective equipment: safety goggles, ear defenders and also a respirator (or breathing protection) if dust is agitated during operation of the power tool. It is also recommended to wear suitable footwear, long trousers and gloves while working with the power tool.
- Keep hair and clothing away from openings and moving parts.

### Brief operation without engaged switch rocker

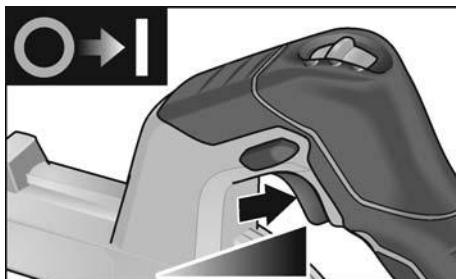

- Press and hold down the switch.
- To switch off, release the switch.

### Continuous operation with engaged switch rocker

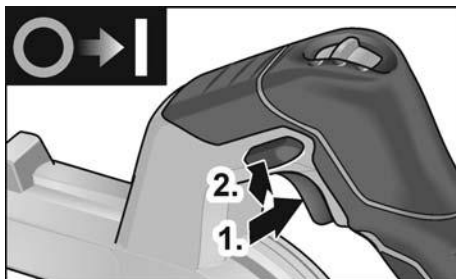

- Press and hold down the switch (1.).
- To lock into position, hold down the locking button (2.) and release the switch.

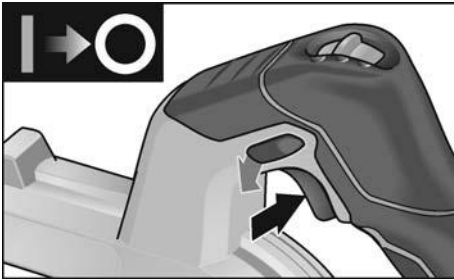

- To switch off, briefly press and release the switch.

### Speed selection

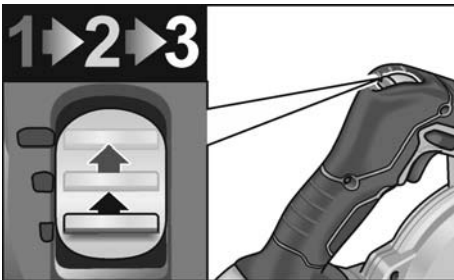

The speed can be preselected in 3 stages between 10,600 and 18,000 rpm.

### Working with the power tool

**⚠ CAUTION!**  
 When it is switched off, the blower continues to run briefly.

### Air sweeping



1. Fit the nozzle.
2. Insert battery.
3. Set the speed to the required setting.

4. Hold the power tool with one hand on the handle and assume the working position.
  5. Switch on the power tool.
- At the end of work:
6. Release the switch.

### Inflating

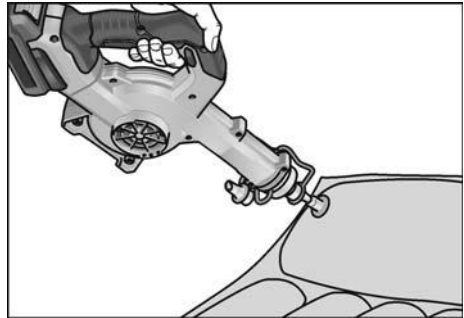

1. Fit the adapter with suitable reducing nozzle on the bayonet connection.
  2. Insert battery.
  3. Attach the reducing nozzle, ensuring an exact fit.
  4. Set the speed to the required setting.
  5. Hold the power tool with one hand on the handle and assume the working position.
  6. Switch on the power tool.
- At the end of work:
7. Release the switch.

### Deflating

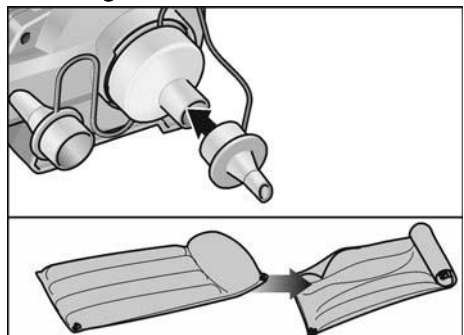

1. Fit the adapter with suitable reducing nozzle on the air inlet.
2. Insert battery.

3. Attach the reducing nozzle, ensuring an exact fit.
4. Set the speed to the required setting.
5. Hold the power tool with one hand on the handle and assume the working position.
6. Switch on the power tool.

At the end of work:

7. Release the switch.

## Charger

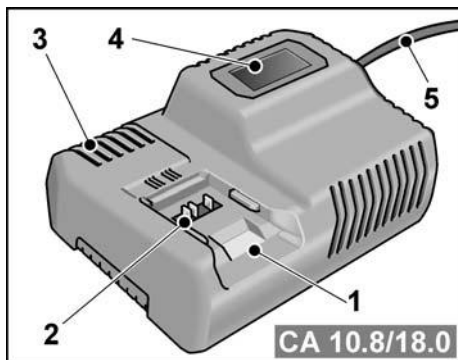

- 1 Insertion slot for battery
- 2 Contacts
- 3 Ventilation slots
- 4 Operating state display
- 5 Power cord with mains plug

The CA 10.8/18.0 charger is designed to charge FLEX batteries of the following types

- AP 10.8 (2.5 Ah),
- AP 18.0 (2.5 Ah),
- AP 10.8 (5.0 Ah),
- AP 18.0 (5.0 Ah).

### Tips for a long battery service life

#### **⚠ CAUTION!**

*Never charge batteries at temperatures below 0 °C or above 55 °C.*

*Do not charge batteries in environments with high air humidity or ambient temperature*

*Do not cover batteries and the charger during the charging process.*

*Pull out the charger mains plug at the end of the charging process.*

Battery and charger heat up during the charging process. This is perfectly normal!

Lithium-ion batteries do not exhibit the established “memory effect”. Nevertheless, a battery should be completely discharged before charging and the charging process should always be fully completed.

If batteries are not used for an extended period of time, store them partially charged in a cool place.

### Charging process

#### **⚠ CAUTION!**

*Insert only original batteries in the supplied charger.*

- Insert the charger mains plug. The display backlighting lights up green for 2 seconds and then goes out again. OK is displayed.

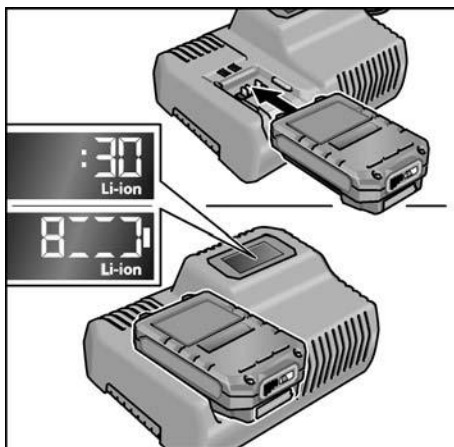

- Insert the battery fully into the charger until it clicks into place.
  - The time remaining in the charging process (until the battery is fully charged) and a graphic representation of the state of charge are shown alternately in the display.
  - The display backlighting lights up orange when the battery is charged less than 80%.
  - When the battery charge reaches 80% the display lights up green and OK is indicated.



- The battery is fully charged when the display  appears.

The green backlighting goes out after a short time.

- Remove the battery from the charger.

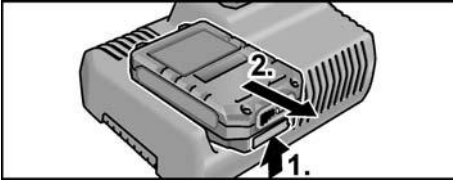

- Pull out the mains plug.

### NOTE

*If the display flashes after the battery is inserted in the charger, there is a fault in the battery or in the charger.*



*Display flashes slowly.  
Backlighting orange.*

*The battery is too hot or too cold. The charging process starts when the battery reaches the charging temperature (0°C...55°C).*



*Display flashes rapidly.  
Backlighting red.*

*Remove the battery from the charger and insert again. If the same display persists, the battery is faulty. Replace the battery or have it checked at an authorised repair shop.*

*If this error message is displayed again with a different battery, this indicates that there is a fault in the charger. Have the charger checked at an authorised repair shop.*

## Maintenance and care

### WARNING!

*Remove the battery before carrying out any work on the power tool.*

## Cleaning

### Cleaning the electric power tool

### WARNING!

*Do not use water or liquid detergents.*

- Regularly blow out the housing interior and motor with dry compressed air.

## Charger

### WARNING!

*Before performing any work, pull out the mains plug. Do not use water or liquid detergents.*

- Remove dirt and dust from the housing with a brush or a dry cloth.

## Repairs

Repairs may be carried out by an authorised customer service centre only.

### NOTE

*During the warranty period do not loosen the screws on the motor housing. Non-compliance will deem the guarantee obligations of the manufacturer null and void.*

## Spare parts and accessories

Other accessories, in particular insertion tools, can be found in the manufacturer's catalogues.

Exploded drawings and spare-part lists can be found on our homepage:

[www.flex-tools.com](http://www.flex-tools.com)

## Disposal information

### WARNING!

*Render redundant power tools unusable:*

- mains operated power tool by removing the power cord,
- battery operated power tool by removing the battery.



EU countries only:

Do not dispose of electric power tools in the household waste!

In accordance with the European Directive 2012/19/EU on Waste Electrical and Electronic Equipment and its incorporation into national law, used power tools must be collected separately and recycled in an environmentally friendly manner.



**Raw material recovery instead of waste disposal.**

Device, accessories and packaging should be recycled in an environmentally friendly manner. Plastic parts are identified for recycling according to material type.

**⚠ WARNING!**

*Do not throw batteries into the household waste, fire or water. Do not open used batteries.*



EU countries only:

In accordance with Directive 2006/66/EC defective or used batteries must be recycled.



**NOTE**

*Please ask your dealer about disposal options!*

## CE-Declaration of Conformity

We declare under our sole responsibility that the product described under "Technical specifications" conforms to the following standards or normative documents:

EN 62841, EN 15503 EN 60335,  
EN 50636 in accordance with the  
regulations of the directives 2014/30/EU,  
2006/42/EC, 2011/65/EU.

Responsible for technical documents:  
FLEX-Elektrowerkzeuge GmbH, R & D  
Bahnhofstrasse 15, D-71711 Steinheim/Murr

Eckhard Rühle  
Manager Research &  
Development (R & D)

Klaus Peter Weinper  
Head of Quality  
Department (QD)

01.11.2018

FLEX-Elektrowerkzeuge GmbH  
Bahnhofstrasse 15, D-71711 Steinheim/Murr

## Exemption from liability

The manufacturer and his representative are not liable for any damage and lost profit due to interruption in business caused by the product or by an unusable product. The manufacturer and his representative are not liable for any damage which was caused by improper use of the product or by use of the product with products from other manufacturers.